

Associated Parts and Components

This section of the Air Pressure Products Catalog contains miscellaneous items that are used with the sensors listed in the preceding pages. In some cases, items may be listed here for discontinued products, such as the Dial-a-Ducer, that are still supported by System Studies Incorporated.

9800-4305 Sensor, Transducer Housing, 5-Bank
9800-4310 Sensor, Transducer Housing, 10-Bank

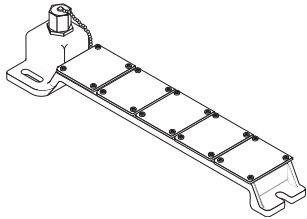

Pressure transducers monitoring cable pressure at utility hole locations are usually installed in a transducer housing. The 5 bank model, 9800-4305, is designed to accommodate up to five transducers. It is supplied with a 15 foot stub containing 6 pairs of 22 gauge PIC for cable or junction box.

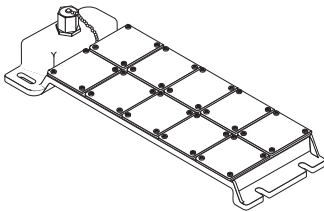

The 10-bank model, 9800-4310, can accommodate up to ten transducers. This housing is equipped with a 15 foot 25 pair stub which eliminates the need for a junction box.

9080-0055 TD Housing Splice Assembly

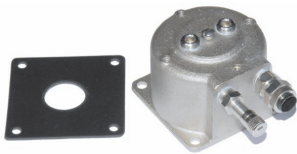

Converting from 6,000 foot to 3,000 foot manifold spacing requires installing a monitored manifold assembly at the midpoint locations. The TD housing Splice Assembly mounts directly to the existing 5-bank or 10-bank Transducer Housing at these locations and simplifies the utilization of existing pairs. It includes a tank valve and a 3/8" conductor pair tubing connection.

9080-0085 Pair Splitter "Y" Connector



When used in conjunction with two TD Housing Splice Assemblies (9080-0055), the Pair Splitter "Y" Connector facilitates the installation of a High Resolution Dual Pressure/Flow Transducer. The "Y" Connector accepts the 3/8" conductor pair tubing from the transducer and splits the pressure and flow pairs for termination at different banks on the transducer housing.

6522-0068 Sensor, Seal, Molded Wire Cover



This molded rubber seal replaces the original o-ring used to provide the water and air tight connection when fitting a wire cover assembly to a System Studies High Resolution Transducer (Part Nos. 9800-4000, -4001, -4002, -4100, -4101, -4102, -4200, -4201 and -4202). The seal has a 2.5" outside diameter (2-3/8" I.D.) and a side height of approximately 3/8".

The new seal sits more securely in the wire cover assembly and eliminates problems inherent with circular, non-seating o-rings.

9900-0026 Tube Replacement Kit, Manifold Monitoring Assembly

9900-0029 Tube Replacement Kit, Manifold Monitoring Assembly, 5-Count



The words High Resolution Pressure Transducer™, High Resolution Flow Transducer™, Dial-a-Ducer™, Selector Pair Saver™, Flow Gauge™, Flow Finder™, PressureMAP™ and 289H LSS™ are trademarks of System Studies Incorporated.

